

GUY-RAYMOND



GRX38 CASTORS

Rollen ■ Roulettes ■ Ruedas

GRX38 CASTOR

SPECIFICATION

CASTOR TYPE

Swivel

MATERIALS

Castor PA
Soft Tyre PUR

STANDARD COLOURS

Black
Aluminium RAL 9006
Grey RAL 7035
White RAL 9003

STANDARDS

EN 12528

TECHNISCHE DATEN

ROLLEN TYP

Lenkrolle

MATERIAL

Rollen PA
Weiche Lauffläche PUR

STANDARDFARBEN

Schwarz
Aluminium RAL 9006
Lichtgrau RAL 7035
Weiss RAL 9003

NORMEN

EN 12528

SPECIFICATION

TYPE DE ROULETTE

Pivotante

MATIERES

Roulette PA
Bandes Souples PUR

COLORIS STANDARD

Noir
Alu RAL 9006
Gris Clair RAL 7035
Blanc RAL 9003

NORMES

EN 12528

ESPECIFICACION

TIPO DE RUEDA

Giratoria

MATERIALES

Rueda Nilón
Rodadura Blanda Poliuretano

COLORES ESTANDAR

Negro
Aluminio RAL 9006
Gris RAL 7035
Blanco RAL 9003

NORMAS

EN 12528



38



38



15



12

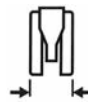

46

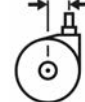

13



39



Up to 60kg(x)
(x)Depends on fixing

NO.

3G00-1
3G00-1-1U

GRX38
GRX38 Soft Tyre

**BLACK HARD WHEEL
BLACK SOFT TYRE**

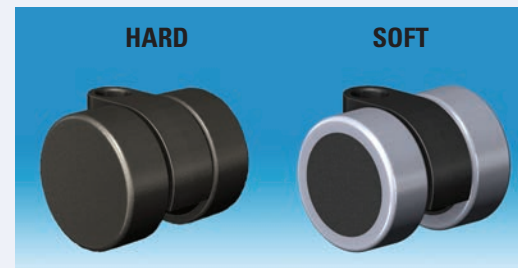

NO.

3G00-64
3G00-64-64-T1U

GRX38 RAL 9006
GRX38 RAL 9006 Soft Tyre

**ALUMINIUM-RAL9006 HARD WHEEL
ALUMINIUM-RAL9006 SOFT TYRE**

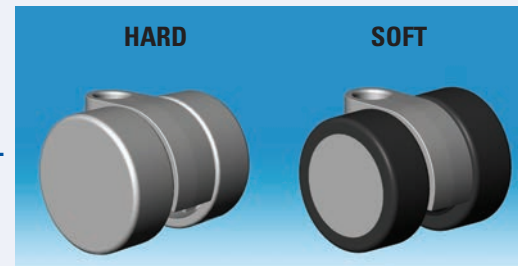

NO.

3G00-25
3G00-25-25U

GRX38 RAL 7035
GRX38 RAL 7035 Soft Tyre

**GREY – RAL 7035 HARD WHEEL
GREY – RAL 7035 SOFT TYRE**

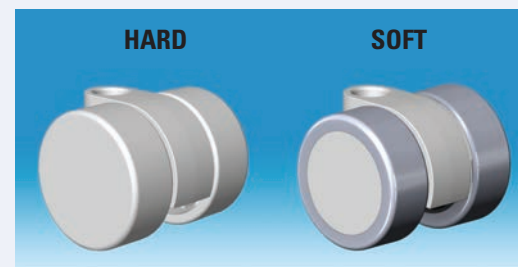

NO.

3G00-3
3G00-3-3U

GRX38 RAL 9003
GRX38 RAL 9003 Soft Tyre

**WHITE – RAL 9003 HARD WHEEL
WHITE – RAL 9003 SOFT TYRE**



GRX38FB WHEEL BRAKE CASTOR

SPECIFICATION

CASTOR TYPE

Wheel Brake

MATERIALS

Castor PA

Soft Tyre PUR

STANDARD COLOURS

Black

Aluminium RAL 9006

Grey RAL 7035

White RAL 9003

STANDARDS

EN 12528

TECHNISCHE DATEN

ROLLEN TYP

Radfeststeller

MATERIAL

Rollen PA

Weiche Lauffläche PUR

STANDARDFARBEN

Schwarz

Aluminium RAL 9006

Lichtgrau RAL 7035

Weiss RAL 9003

NORMEN

EN 12528

SPECIFICATION

TYPE DE ROULETTE

Blocage de Roue

MATIERES

Roulette PA

Bandes Souples PUR

COLORIS STANDARD

Noir

Alu RAL 9006

Gris Clair RAL 7035

Blanc RAL 9003

NORMES

EN 12528

ESPECIFICACION

TIPO DE RUEDA

Freno de Rueda

MATERIALES

Rueda Nilón

Rodadura Blanda Poliuretano

COLORES ESTANDAR

Negro

Aluminio RAL 9006

Gris RAL 7035

Blanco RAL 9003

NORMAS

EN 12528



38



38



15



12

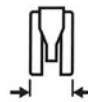

46

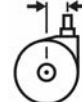

13



47.5



Up to 60kg(x)
(x)Depends on fixing

NO.

3H00-1
3H00-1-1U

GRX38FB
GRX38FB Soft Tyre

**BLACK HARD WHEEL
BLACK SOFT TYRE**

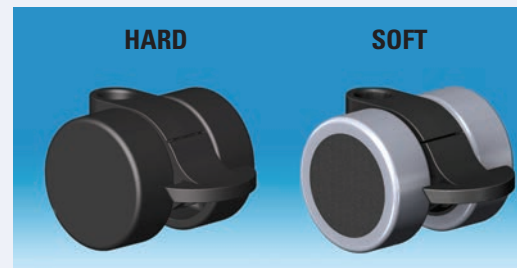

NO.

3H00-64
3H00-64-64-T1U

GRX38FB RAL 9006
GRX38FB RAL 9006 Soft Tyre

**ALUMINIUM-RAL 9006 HARD WHEEL
ALUMINIUM-RAL 9006 SOFT TYRE**

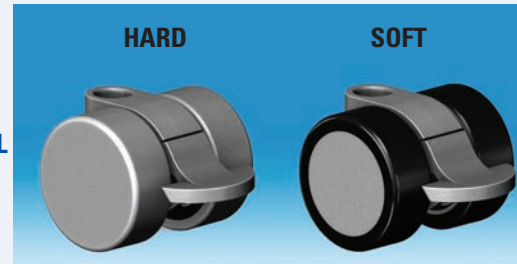

NO.

3H00-25
3H00-25-25U

GRX38FB RAL 7035
GRX38FB RAL 7035 Soft Tyre

**GREY – RAL 7035 HARD WHEEL
GREY – RAL 7035 SOFT TYRE**

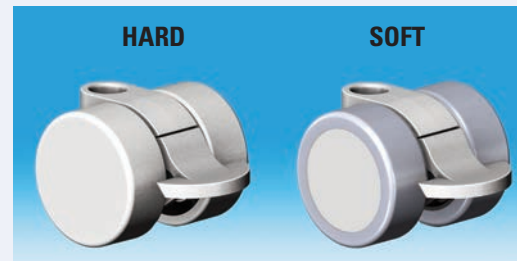

NO.

3H00-3
3H00-3-3U

GRX38FB RAL 9003
GRX38FB RAL 9003 Soft Tyre

**WHITE – RAL 9003 HARD WHEEL
WHITE – RAL 9003 SOFT TYRE**

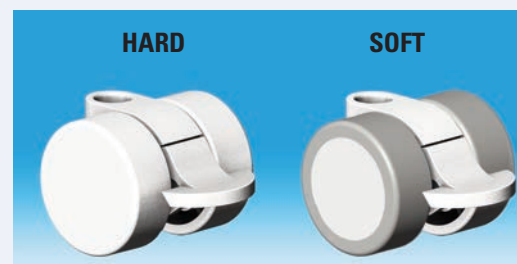

SPECIFICATION

MATERIALS

Steel BZP

TECHNISCHE DATEN

MATERIAL

Stahl Verzinkt

SPECIFICATION

MATIERES

Acier, plaqué de zinc

ESPECIFICACION

MATERIALES

Acero chapado de zinc

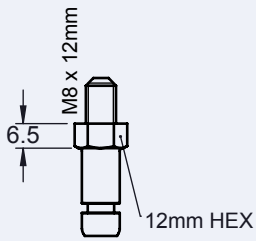

M8 x 12mm
No.19M2P

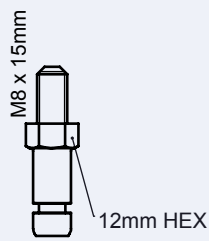

M8 x 15mm
No.19M3P

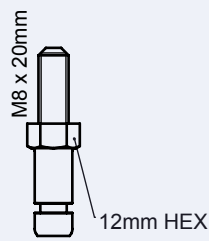

M8 x 20mm
19M4P

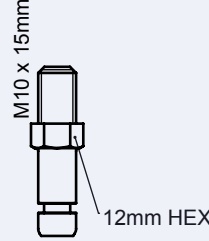

M10 x 15mm
No.19M0P

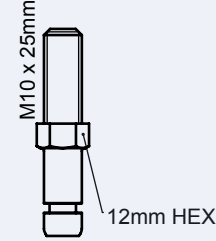

M10 x 25mm
No.19M1P

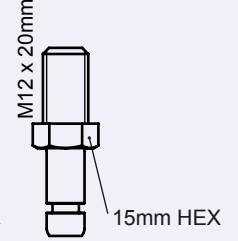

M12 x 20mm
No.19M5P

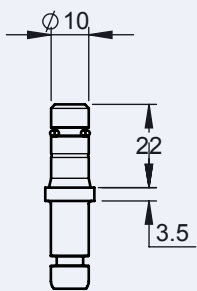

Ø 10 x 22mm
No.19M8P

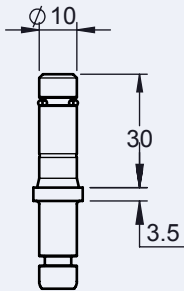

Ø 10 x 30mm
No.19M9P

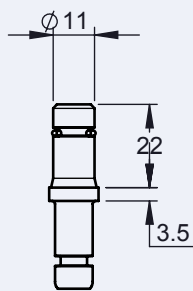

Ø 11 x 22mm
No.19M6P

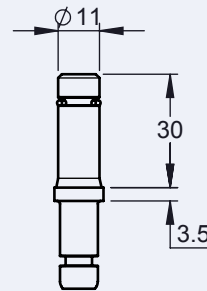

Ø 11 x 30mm
No.19M7P

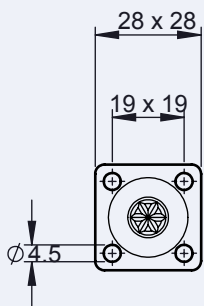

PLATE FIXING
No.19N0-9231

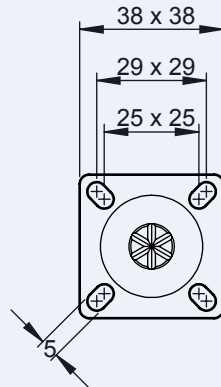

PLATE FIXING
No.19N1-9209

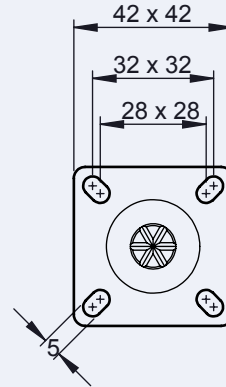

PLATE FIXING
No.19N1-9211

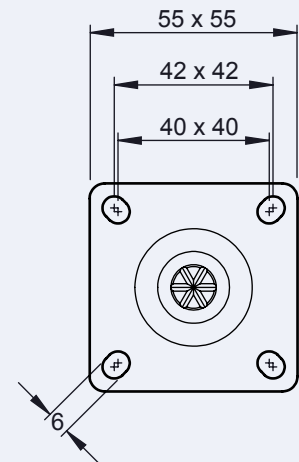

PLATE FIXING
No.19N2-9215

